



# MEMS Mass Flow Sensor

For fuel metering applications

FS5200 Series

**FS5200 series gas flow sensors** are designed for home appliance fuel efficiency applications such as natural gas water heater, LPG and other fuel appliances. It is built with the Company's proprietary 3<sup>rd</sup> generation MEMS D-thermal sensor with the option for heat value data.

The sensor can be fully customized for data output format, mechanical connections and other application specified features.

## Dimensions

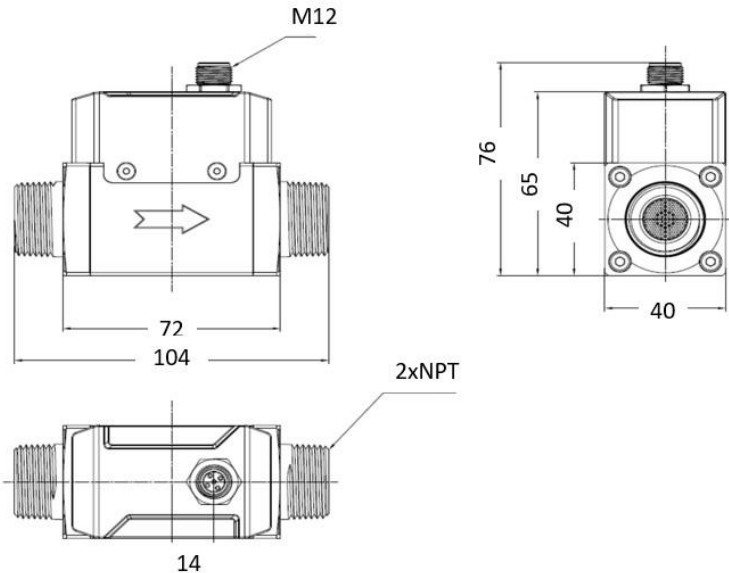

**Siargo Ltd.**  
Santa Clara, California  
[www.Siargo.com](http://www.Siargo.com)  
408.969.0368  
[info@Siargo.com](mailto:info@Siargo.com)



## Specifications

Accuracy	$\pm(1.5+0.15FS)$	%
Rangeability	100:1	
Pressure rating	1.0	MPa
Temperature, gas	-10 ~ 65	°C
Temperature, environment	-20~60	°C
Humidity	<95 (no condensation)	%RH
Power supply	8~24	Vdc
Output	Instant flow rate	
Data interface	RS485 Modbus and voltage 1~5Vdc	
Data cable	M12	
Mechanical	NPT or customized	
Protection	IP54	
Compliance	RoHS, REACH, EN 61326-1	
Calibration	20°C, 101.325 kPa	
Storage temperature	-20 ~ 70	°C

## Product selection

Model	DN (mm)	Flow range			
		L/min, NG	L/min, LPG	SCFH, NG	SCFH, LPG
FS5208	3/8"	0~50	0~25	0~110	0~60
FS5212	1/2"	0~200	0~100	0~450	0~250
FS5219	3/4"	0~300	0~150	0~650	0~350

**Note:** For other gases and flow ranges, please contact the manufacturer.